

JAC



JAC FORKLIFT

H Series Internal Combustion
Counterbalanced Forklift Truck

CPC10H / CPCD10H / CPC15H / CPCD15H / CPC18H / CPCD18H
CPC20H / CPCD20H / CPC25H / CPCD25H / CPC30H / CPCD30H
CPC35H / CPCD35H / CPC38H / CPCD38H / CPC40H / CPCD40H



JAC HEAVY DUTY IMPORT & EXPORT CO.,LTD





MATERIAL HANDLING EXPERTS FROM AUTOMOTIVE QUALITY



✉ contact@gmm-mg.com
📍 Route du Pape Alarobia (face sanifer)
📞 +261 32 03 111 33 / +261 32 03 111 34 / +261 32 03 111 36



Move forward

Selling Points Of H Series 1-4t Internal Combustion Counterbalanced Forklift Trucks

Four Highlights

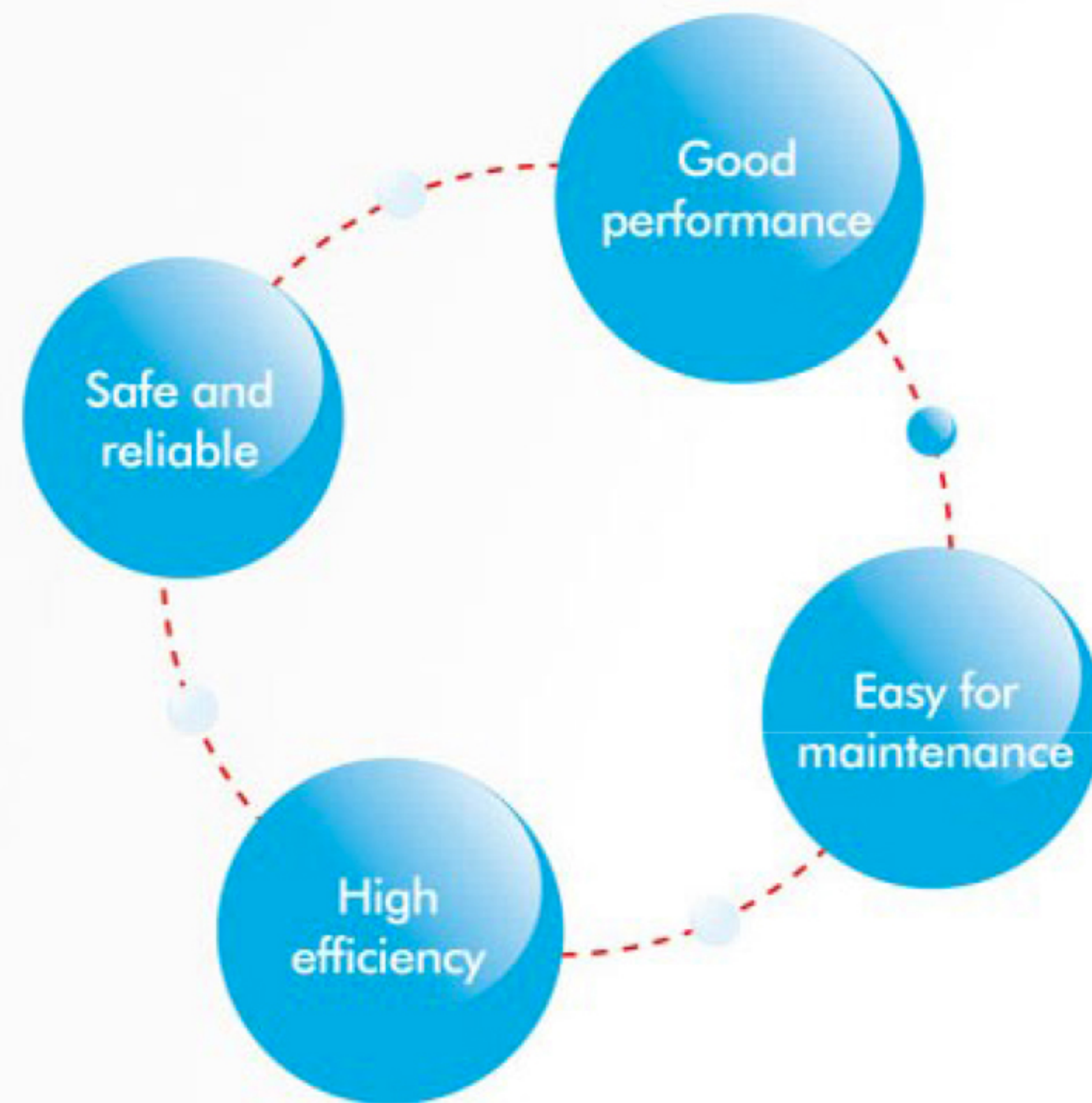

No.1 Good performance

◆ Delayed power-off—The first in China

The machine will be powered off in case the machine has been powered on but not in use for at least 10 minutes, which is safe and energy-saving.

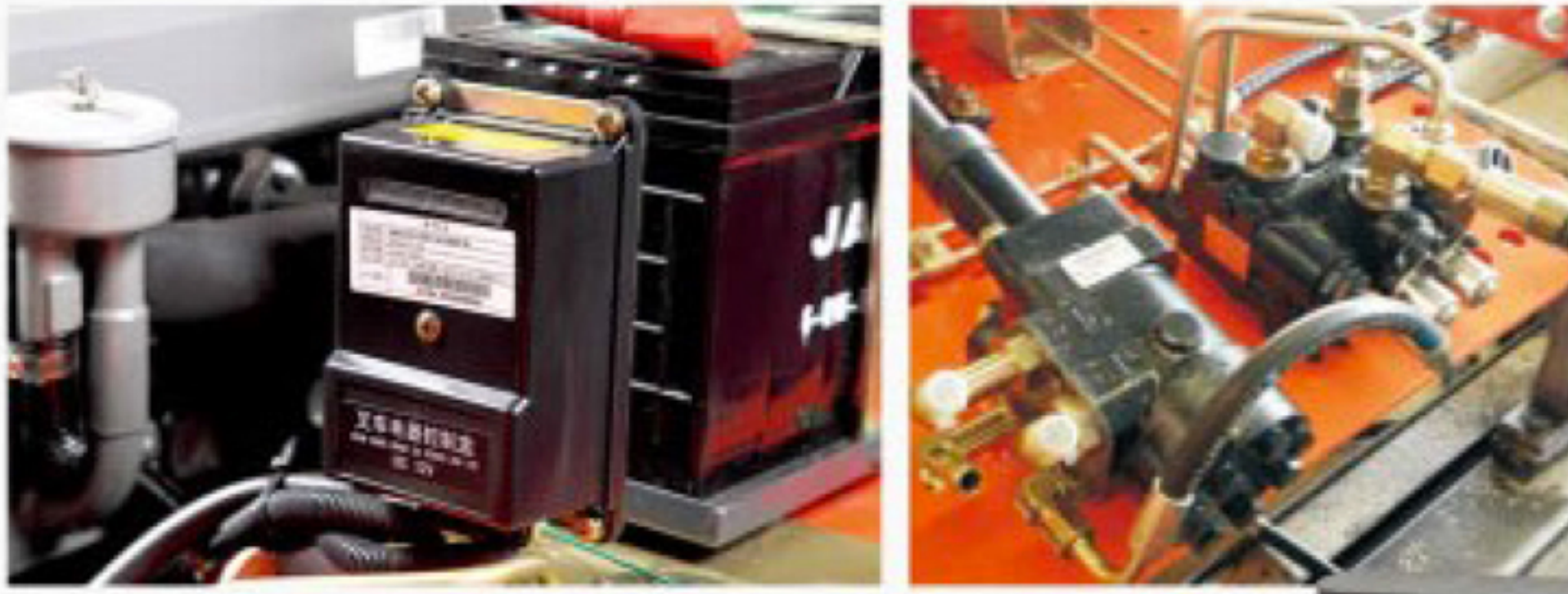

◆ Load sensing hydraulic system

Load-sensitive hydraulic system ensures the fork to lift with full load while the engine is running idly so as to reduce fuel consumption.

◆ Improved longitudinal stability of the forklift

Stability is better than other products of same class.

◆ Strengthened chassis

Integrated design with strengthened tail stock ensures safer operation.

◆ Enhanced working unit

Lifting speed is improved by 5%.

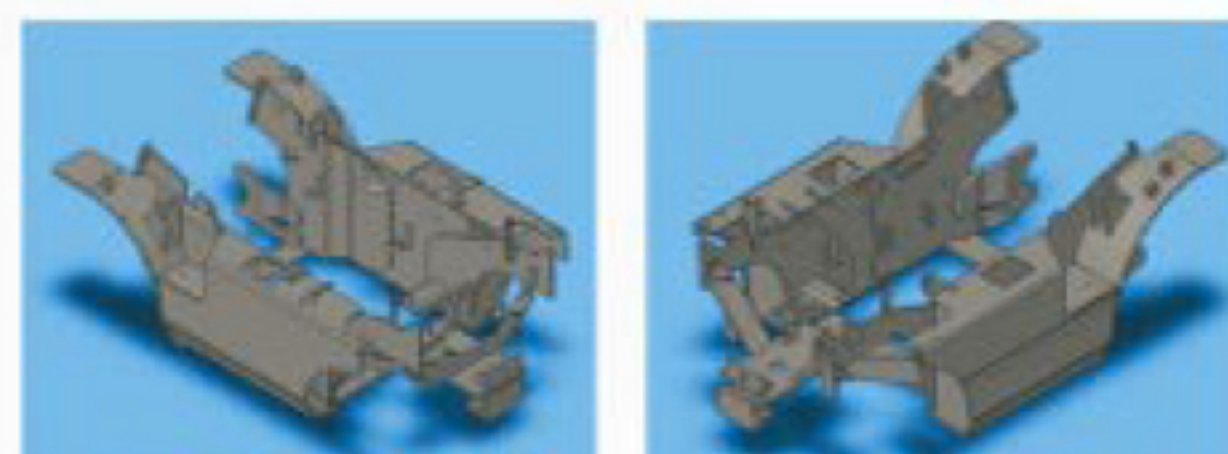

◆ Three-gear drive mode

Mast, chains and oil tanks of 1-3.5t internal combustion forklift are enhanced for operation with heavy load.



No.2 Safe and reliable

◆ Engine electrical system adopts water-proof connectors

The imported water-proof connectors are more reliable.

Water-proof grade Ip65

◆ Reliable sealing of oil tank cover

The cover adopts flange sealing against leak.



◆ 24° cone+Oring

The hydraulic system adopts the most advanced sealing.

◆ High quality hydraulic system

The system is equipped with a return oil filter to improve reliability and service life.

◆ Battery insulation plate

Insulation plates are provided between the battery and exhaust pipe for 2-3.5t internal combustion forklift to prolong service life of battery.

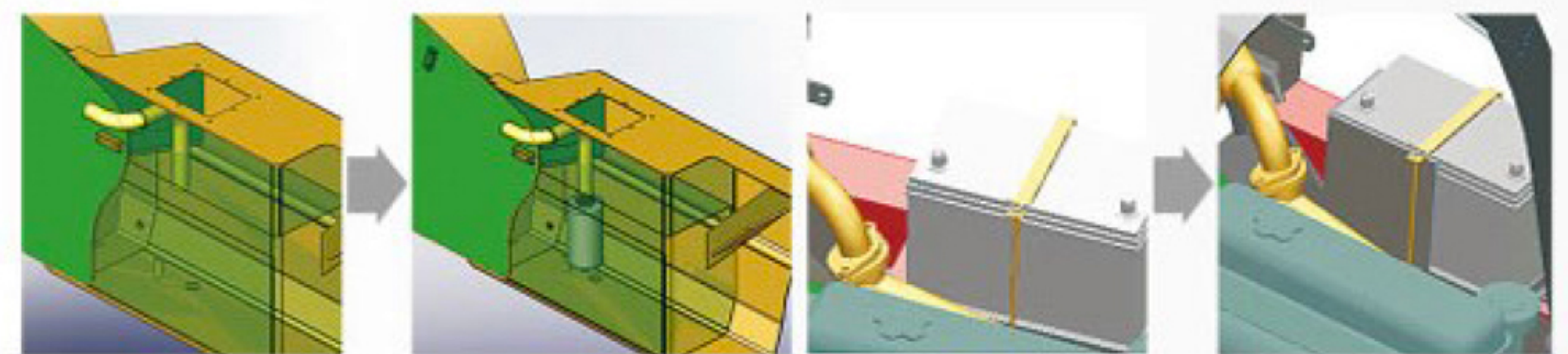

No.3 High efficiency

◆ Spacious cab

Ergonomics-based design ensures easy operation.

◆ Wide mast

Wide mast broadens visual field.



No.4 Easy for maintenance

◆ Early-warning of instruments service is provided

Regular early-warning of instruments service realizes intelligent service.

◆ Large opening angle of engine hood

The engine hood can be lifted to 80° for easy maintenance.



contact@gmm-mg.com
Route du Pape Alarobia (face sanifer)
+261 32 03 111 33 / +261 32 03 111 34 / +261 32 03 111 36



Move forward

SPECIFICATIONS

Model		CPCD10H	CPCD15H	CPCD18H	CPC10H	CPC15H	CPC18H	CPCD20H	CPCD25H	CPC20H	CPC25H	CPCD30H	CPCD35H	CPC30H	CPC35H	CPC38H	CPCD38H	CPC40H	CPCD40H	
1	Power type	Diesel																		
2	Rated load	kg	1000	1500	1800	1000	1500	1800	2000	2500	2000	2500	3000	3500	3000	3500	3800		4000	
3	Load center distance	mm	500			500			500			500			500			500		
4	Lift height	mm	3000			3000			3000			3000			3000			3000		
5	Free lift height	mm	155			240			165			110								
6	Fork size	L x W x T	920 x 100 x 40			1070 x 122 x 40			1070 x 125 x 45			1070 x 125 x 50			1070 x 125 x 45			1070 x 125 x 50		
7	Mast tilt angle	FR/RR	6/12			6/12			6/12			6/12			6/12			6/12		
8	Minimum turning radius	mm	1880	1955	1985	1880	1955	1985	2170	2230	2170	2230	2550	2570	2550	2570	2835			
9	Minimum right angle stacking	mm	3290	3365	3395	3290	3365	3395	3635	3695	3635	3695	4025	4045	4025	4045	4325			
10	Minimum right angle aisle width	mm	2080	2155	2185	2080	2155	2185	2370	2430	2370	2430	2750	2770	2750	2770	3035			
11	Minimum ground clearance	mm	110			110			110			130			138					
12	Height of overhead guard	mm	2060			2070			2090			2140			2140					
13	Overhang(FR)	mm	410			465			475			490			490					
14	Maximum travel speed	Full load	km/h			14.6			18			18			19			19		
15	Maximum lift speed	Full load	mm/s			510			500			560			430			431		
16	Maximum drawbar pull	Full load	KN			12			14			19			12			14		
17	Gradeability	%	20			20			18			20			18			15		
18	Overall length	Without forks	mm	2160	2235	2270	2160	2235	2270	2505	2580	2505	2580	2765	2800	2765	2800	2950		
19	Overall width	mm	1080			1160			1230			1410			1410					
20	Fork height at maximum lift(with)	mm	3930			3944			4230			4220			4220					
21	Mast height	mm	2010			1995			2075			2120			2125					
22	Tires	Front wheel	6.50-10-10PR			7.00-12-12PR			28 x 9-15-14PR			250-15-16PR			250-15-16PR					
23		Rear wheel	5.00-8-10PR			6.00-9-10PR			6.50-10-10PR			6.50-10-10PR			6.50-10-10PR					
24	Wheelbase	mm	1400			1600			1760			1900			1900					
25	Tread	Front wheel/rear wheel	891/920			970/970			1000/970			1160/1065			1160/1065					
26	Self weight	Without load	Kg			2430			2790			2890			2430			2790		
27	Battery	Voltage/capacity	V/Ah			12/80			12/80			12/80			12/80			12/80		
28		Model	Xinchang 4N23G31			Xinchang 4D27G31			Xinchang 4D27G31			Xinchang 4D30G31			Xinchang 4D30G31			Quanchai 4C4-50V31		
29		Rated output	kw/r.p.m			30/2600			36.8/2500			36.8/2500			36.8/2500			36.8/2500		
30		Rated torque	Nm/r.p.m			131/1700-1900			156/1700-1900			156/1700-1900			174/1800-2000			185/1800		
31		Bore x stroke	mm			85 x 100			90 x 105			90 x 105			95 x 105			98 x 105		
32		Number of cylinders	4			4			4			4			4			4		
33		Displacement	L			2.27			2.67			2.67			2.98			3.168		
34	Fuel tank capacity	L	49			55			55			66			66			66		
35	Transmissions(FWD/RWD)		1/1 Manual shift			2/2 Manual shift			1/1 Manual shift			2/2 Manual shift			1/1 Manual shift			2/2 Manual shift		
36	Operating pressure	Mpa	15.5			18.5			18.5			14.5			14.5			14.5		
37	Tire type(FR/RR)		Pneumatic			Pneumatic			Pneumatic			Pneumatic			Pneumatic			Pneumatic		
38	Number of wheels(FR/RR)	Pcs	2/2			2/2			2/2			2/2			2/2			2/2		
39	Lowering speed(full load)	mm/s	370			450			460			330			460			330		
40	Lowering speed(no load)	mm/s	640			500			430			330			430			330		
41	Axle load distribution(full)	kg	2840/380	3640/520	4040/600	2840/380	3640/520	4040/600	4740/660	5470/805	4740/660	5470/805	6270/870	7015/945	6240/860	6980/940	7870/960	7890/980	8160/1000	8180/1020
42	Axle load distribution(no)	kg	1220/1020	1170/1490	1140/1750	1220/1020	1170/1490	1140/1750	1415/1340	1475/2305	1415/1340	1475/2305	1640/2500	1660/2800	1620/2480	1650/2770	2020/3010	2040/3030	2070/3090	2090/3110

Calculation of minimum right angle stacking aisle width: Pallet size: 1100mm×1100mm, total clearance(FR/RR):100mm

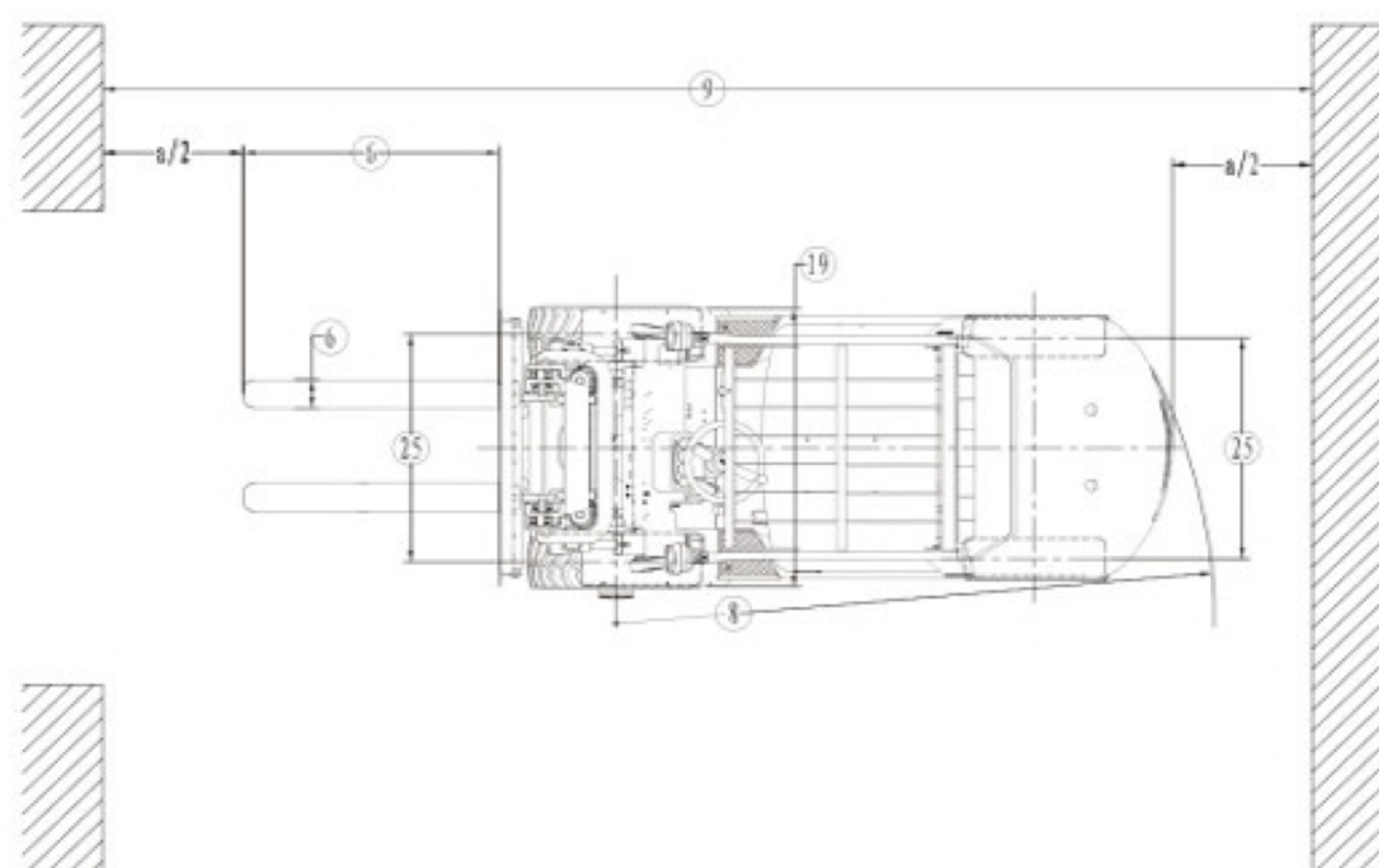
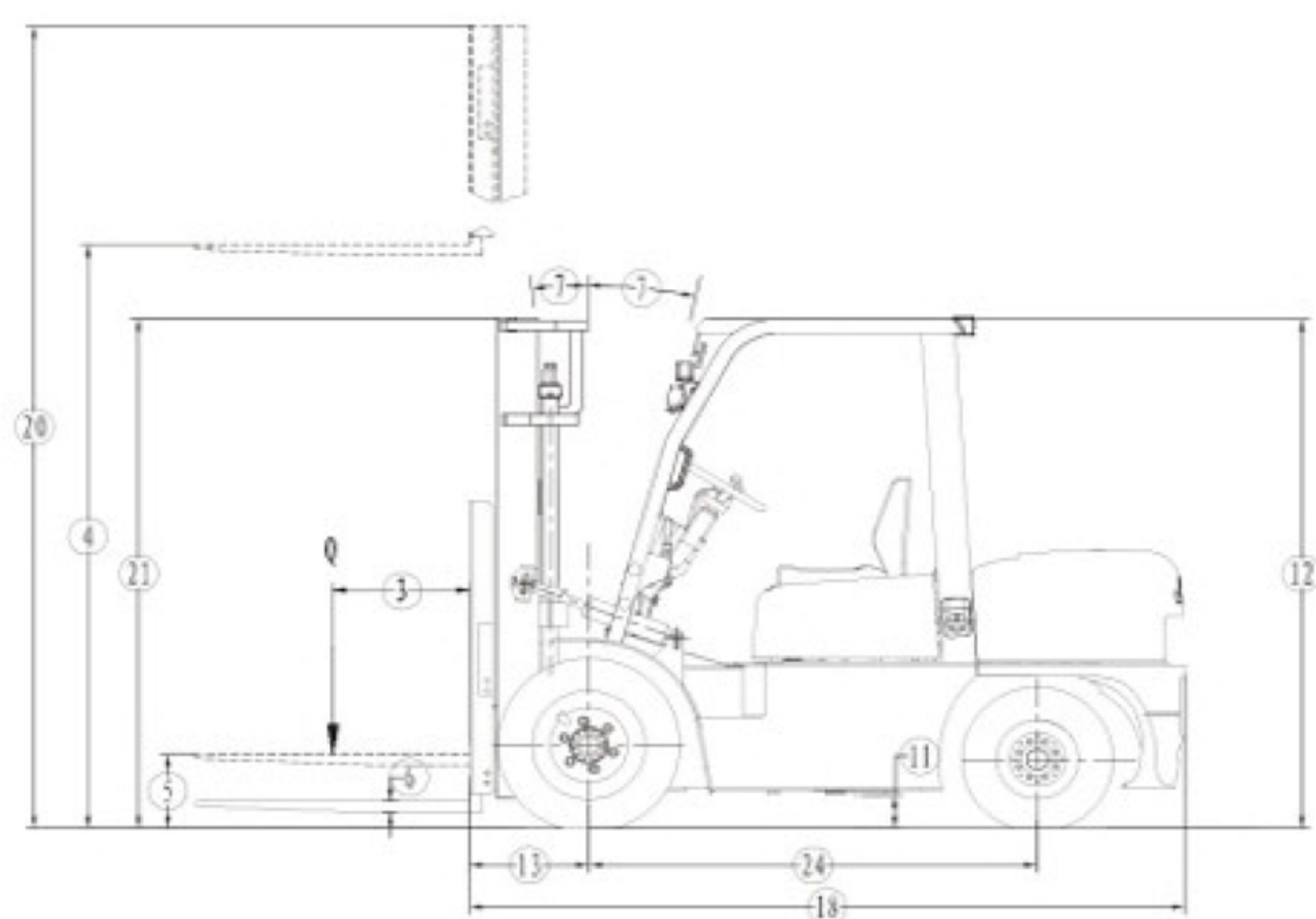

DIMENSIONAL DRAWING



contact@gmm-mg.com
 Route du Pape Alarobia (face sanifer)
 +261 32 03 111 33 / +261 32 03 111 34 / +261 32 03 111 36



Move forward

LOAD CAPACITY

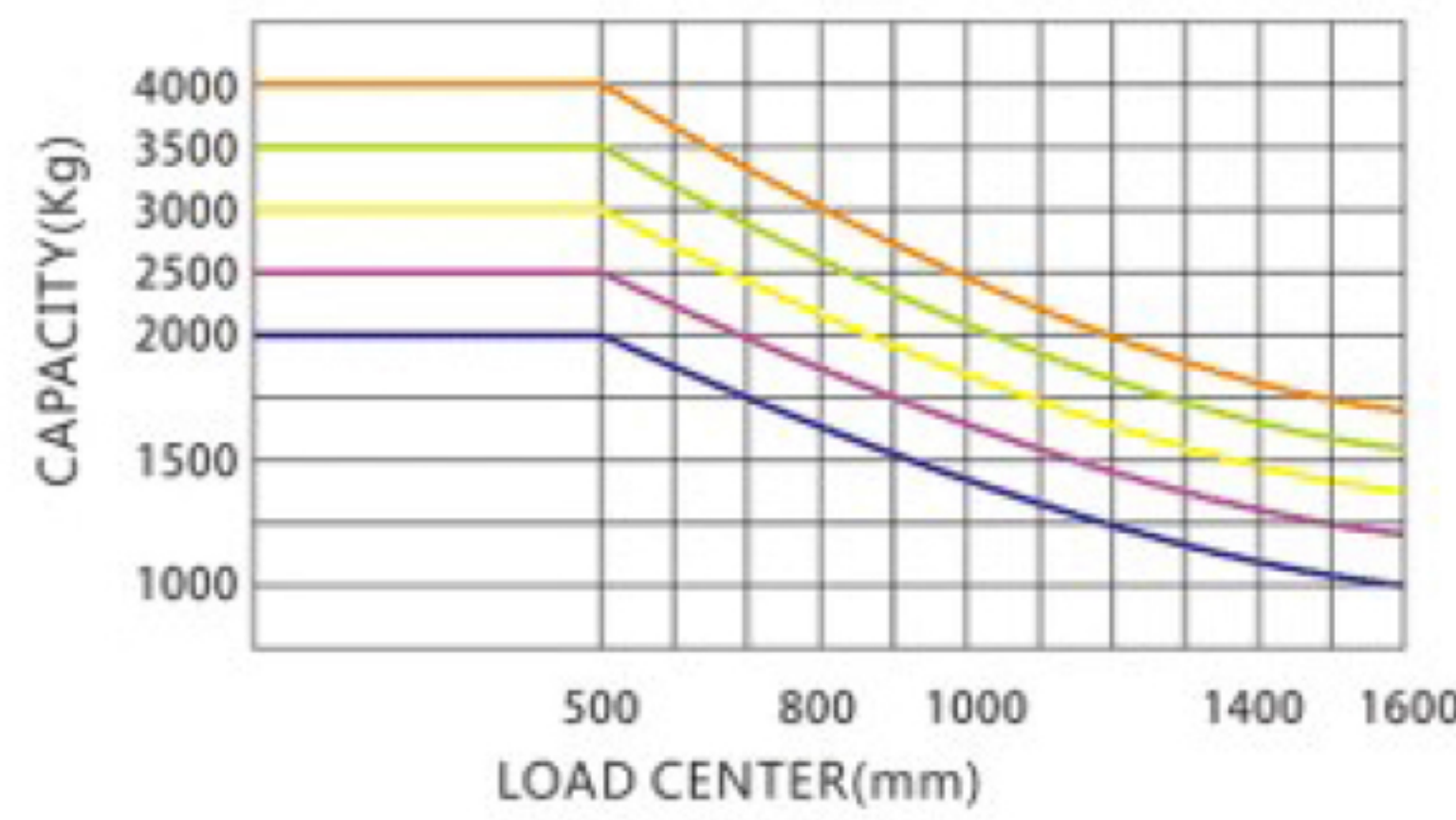
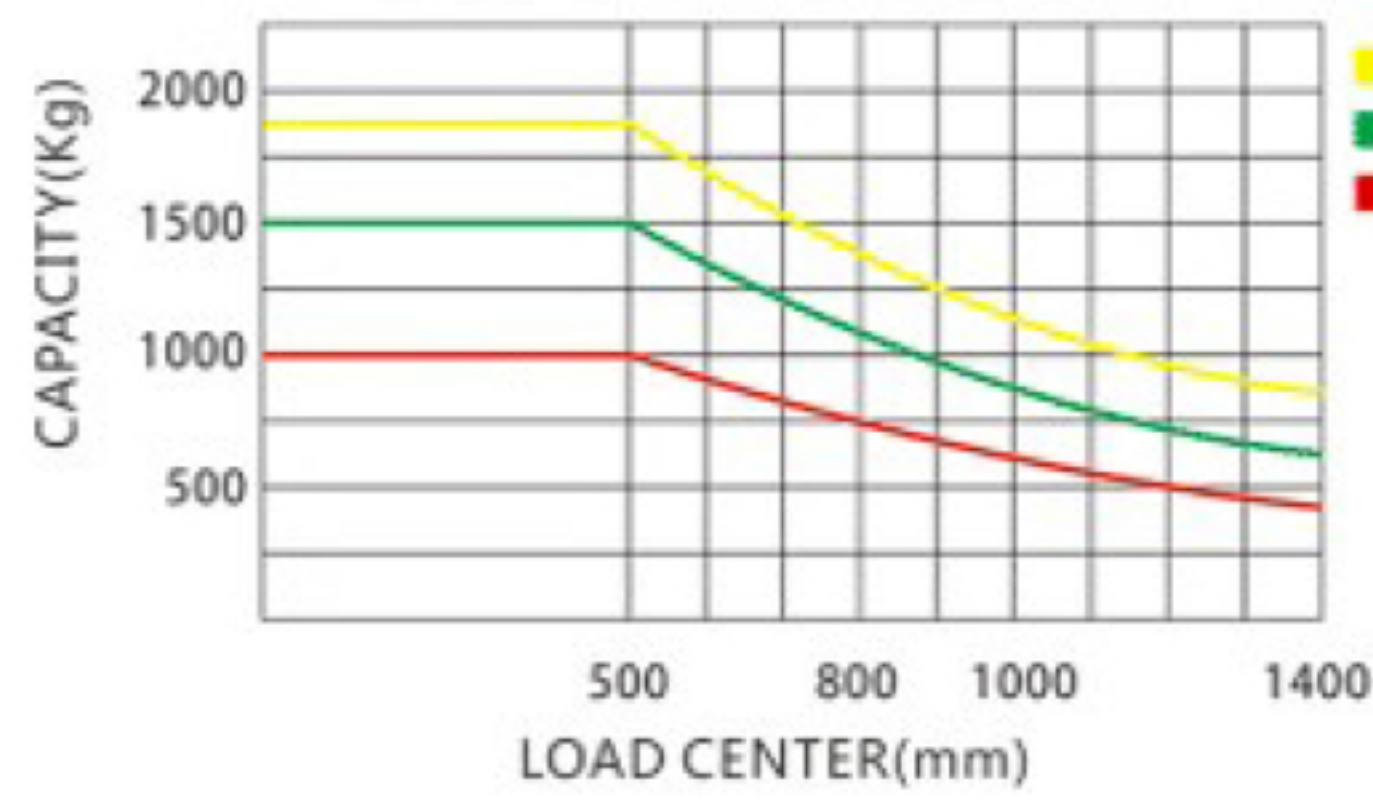

Note: the vertical axis represents the CAPACITY and the horizontal axis represents the LOAD CENTER. The calculation of LOAD CENTER starts with the frontage of fork. The basic point of standard load refers to the center of a cube with load side 1000mm long. The CAPACITY will drop if the mast tilts forwards, a non-standard fork is adopted or the load width is excessive. The CAPACITY at the LOAD CENTER could be timely learnt of through the load curve.

STANDARD EQUIPMENT

- Standard forks
- Standard seat
- Charging indication
- Backrest
- Backup light
- Back-up buzzer
- Side mirror
- Light switch
- Lamp bracket
- Electric horn
- 2-piece selector valve
- Engine choke
- Direction switch
- Combination taillight
- Rain cover of overhead guard
- Durable rib tire
- Hour meter
- Air cleaner clogging alarm
- WFOV mast
- Cable type parking brake
- Lift/tilt lever
- Lift circuit governor valve
- Drawbar pin
- Headlight
- Tilt adjustable steering wheel
- Tilt circuit self-locking valve
- Full hydraulic power steering
- Overhead air intake system
- Handle
- Coolant temperature gauge
- Tool kit
- Rubber pedal pad
- Cyclone air cleaner
- Pointer type instrument cluster
- LCD instrument cluster
- Hydraulic return filter element
- Hydraulic suction filter element
- Hydraulic oil scale
- Oil pressure alarm
- Key switch
- Brake
- Turn signal light

OPTIONS EQUIPMENT

- de shifter
- Boom
- Windshield
- Hook
- 2(3)-section full free mast
- Deluxe seat
- High exhaust pipe
- Lengthened forks
- Lengthened fork cover
- Cab
- Cab heater
- Exhaust purification muffler
- Muffler with spark arrester
- Jib
- Hinged forks
- 3-section full free mast
- Solid tire
- Dual air filter
- Rotating beacon
- User specified color
- Paper roll clamp
- Colored tire(white, green)
- Small fan

ENGINE TYPE SELECTION AND PARAMETERS

No.	Manufacturer	Power type	Model	Number of cylinders	Bore x stroke	Total displacement	Rated output/RPM	Rated torque/RPM	Emission standard	Applicable forklift truck(Tonnage range)
					mm					
1	Xinchang, China	Diesel	NC485BPG-504A	4	85 x 100	2.270	30/2600	131/1700-1900	Nationa Stage II	1-1.8t
2	Xinchang, China	Diesel	A490BPG-63A	4	90 x 100	2.540	36.8/2650	148/1800-2000	Nationa Stage II	2-2.5t
3	Xinchang, China	Diesel	C490BPG-203A	4	90 x 105	2.670	40/2650	160/1800-2000	Nationa Stage II	2-3.5t
4	Xinchang, China	Diesel	A495BPG-510A	4	95 x 105	2.980	42/2650	174/1800-2000	Nationa Stage II	3-3.5t
5	Xinchang, China	Diesel	A498BPG	4	98 x 105	3.170	45/2500	205/1600-1800	Nationa Stage II	4t
6	Xinchang, China	Diesel	C490BPG-30	4	90 x 105	2.670	36.8/2650	156-1700-1900	EU stage III	2-3.5t
7	Quanchai, China	Diesel	4B4-45M22	4	85 x 100	2.270	32/2600	140/1800-2000	Nationa Stage II	1-1.8t
8	Quanchai, China	Diesel	QC490GP	4	90 x 105	2.670	39/2650	157/1800-2000	Nationa Stage II	2-2.5t
9	Quanchai, China	Diesel	QC495G	4	95 x 105	2.980	42/2650	174/1800-2000	Nationa Stage II	3-3.5t
10	Quanchai, China	Diesel	4C2-50M42	4	90 x 105	2.670	36.8/2500	150-154/1800	Beijing Stage IV	3-3.5t
11	JAC, China	Diesel	4DA1	4	93 x 102	2.770	39/2550	165/1800-2100	Nationa Stage II	1-3.5t
12	JAC, China	Diesel	4DC1	4	94.5 x 107	3.002	45/2500	185/1600-1800	Nationa Stage II	2-3.5t
13	Deutz FAW, China	Diesel	CA498-06T2/01	4	98 x 105	3.168	45/2500	190/1800	Nationa Stage II	2-4t
14	Guangqing, China	Gasoline	GQ4Y	4	91 x 86	2.237	36.5/2500	155/1800	—	1-3.5t
15	Guangqing, China	LPG	GQ4Y-LPGD	4	91 x 86	2.237	34.5/2500	142/1800	—	1-3.5t
16	Isuzu, Japan	Diesel	AK-C240PKJ-30	4	86 x 102	2.370	34.3/2500	137.7/1800	EU stage III	1-3.5t
17	Isuzu, Japan	Diesel	4JG2PE-01	4	95.4 x 107	3.059	44.9/2450	184.7/1700	EU stage II	3-4t
18	Yanmar, Japan	Diesel	Yanmar 4TNV94L-BXPHZ	4	94 x 110	3.054	34.6/2400	191.5-208.5/1500	EU stage III,Tier3	2-3.5t
19	Yanmar, Japan	Diesel	4TNE 98	4	98 x 110	3.319	42.1/2300	177.6 - 196.3/1700 ± 100	EU stage III,Tier3	3-3.5t
20	Mitsubishi, Japan	Diesel	S4S-455	4	94 x 120	3.330	34.4/2250	170/1700	EU stage IIIA	3.8-4t
21	Nissan, Japan	Gasoline	K21	4	83 x 100	2.164	31.2/2250	143.7/1600	—	1-2.5t
22	Nissan, Japan	Gasoline	K25	4	89 x 100	2.488	37.4/2300	176.5/1600	—	2-3.5t
23	Nissan, Japan	LPG	K21/LPG	4	83 x 100	2.164	28.1/2250	144.9/1800	—	1-2.5t
24	Nissan, Japan	LPG	K25/LPG	4	89 x 100	2.488	35.9/2300	171.2/1600	—	2-3.5t
25	Cummins	Diesel	QSF2.8	4						

SPECIFICATION TABLE OF FORKS

Applicable models	Standard equipment	Width	Thickness	Length series									Mounting class
	LxWxT			L									
	mm	mm	mm	mm									
1t	920x100x35	100	35	770	920	1070	1220	1370	1520	—	—	—	II
1.5t	920x100x35	100	35	770	920	1070	1220	1370	1520	—	—	—	II
1.8t	1070x100x40	100	35	770	920	1070	1220	1370	1520	—	—	—	II
2t	1070x122x40	122	40	770	920	1070	1220	1370	1520	1670	1820	1970	II
2.5t	1070x122x40	122	40	770	920	1070	1220	1370	1520	1670	1820	1970	II
3t	1070x125x45	125	45	770	920	1070	1220	1370	1520	1670	1820	1970	III
3.5t	1070x125x50	125	50	770	920	1070	1220	1370	1520	1670	1820	1970	III
4t	1070x150x55	150	50	770	920	1070	1220	1370	1520	1670	1820	1970	III

2M WFOV BASIC MAST

Lift height	Load capacity																Overall height of mast																										
																	1-1.8t				2-2.5t				3t				3.5t				4t										
	1t		1.5t		1.8t		2t		2.5t		3t		3.5t		4t		Forks(on the ground)	Fully extended		Mast tilt angle		Forks(on the ground)	Fully extended		Mast tilt angle		Forks(on the ground)	Fully extended		Mast tilt angle		Forks(on the ground)	Fully extended		Mast tilt angle		Forks(on the ground)	Fully extended		Mast tilt angle			
	Single tire	Dual tire	Single tire	Dual tire	Single tire	Dual tire	Single tire	Dual tire	Single tire	Dual tire	Single tire	Dual tire	Single tire	Dual tire	Single tire	Dual tire		Single tire	Dual tire	Single tire	Dual tire		Single tire	Dual tire	Single tire	Dual tire		Single tire	Dual tire	Single tire	Dual tire		Single tire	Dual tire	Single tire	Dual tire		Single tire	Dual tire	Single tire	Dual tire		
2000	1000	1000	1500	1500	1750	1750	2000	2000	2500	2500	3000	3000	3500	3500	—	—	1510	2930	2560	6/12	6/12	1495	2944	2594	6/12	6/12	1575	3230	2700	6/12	6/12	1620	3230	2700	6/12	6/12	—	—	—	—	—	—	
2500	1000	1000	1500	1500	1750	1750	2000	2000	2500	2500	3000	3000	3500	3500	4000	4000	1760	3430	3060	6/12	6/12	1745	3444	3094	6/12	6/12	1825	3730	3200	6/12	6/12	1870	3730	3200	6/12	6/12	1875	3722	3372	6/12	6/12		
2700	1000	1000	1500	1500	1750	1750	2000	2000	2500	2500	3000	3000	3500	3500	4000	4000	1860	3630	3260	6/12	6/12	1495	2944	3294	6/12	6/12	1925	3930	3400	6/12	6/12	1970	3930	3400	6/12	6/12	1975	3922	3572	6/12	6/12		
3000	1000	1000	1500	1500	1750	1750	2000	2000	2500	2500	3000	3000	3500	3500	4000	4000	2010	3930	3560	6/12	6/12	1745	3444	3594	6/12	6/12	2075	4230	3700	6/12	6/12	2120	4230	3700	6/12	6/12	2125	4220	3870	6/12	6/12		
3300	1000	1000	1500	1500	1750	1750	2000	2000	2500	2500	3000	3000	3500	3500	4000	4000	2160	4230	3860	6/12	6/12	1845	4444	3894	6/12	6/12	2225	4530	4000	6/12	6/12	2270	4530	4000	6/12	6/12	2275	4520	4170	6/12	6/12		
3500	1000	1000	1500	1500	1750	1750	2000	2000	2500	2500	3000	3000	3500	3500	4000	4000	2260	4430	4060	6/12	6/12	1995	3644	4094	6/12	6/12	2325	4730	4200	6/12	6/12	2370	4730	4200	6/12	6/12	2375	4720	4370	6/12	6/12		
3600	1000	1000	1500	1500	1750	1750	2000	2000	2500	2500	3000	3000	3500	3500	—	—	2310	4530	4160	6/12	6/12	2145	3944	4194	6/12	6/12	2375	4830	4300	6/12	6/12	2420	4830	4300	6/12	6/12	—	—	—	—	—	—	
3700	1000	1000	1500	1500	1750	1750	2000	2000	2500	2500	3000	3000	3500	3500	—	—	2360	4630	4260	6/6	6/6	2245	4244	4294	6/6	6/12	2425	4930	4400	6/6	6/12	2470	4930	4400	6/6	6/12	—	—	—	—	—	—	
3750	—	—	—	—	—	—	—	—	—	—	—	—	—	—	4000	4000	—	—	—	—	—	—	—	—	—	—	—	—	—	—	—	—	—	—	—	—	—	—	—	—	—	—	—
4000	1000	1000	1500	1500	1750	1750	2000	2000	2500	2500	2850	3000	3500	3500	4000	4000	2560	4930	4560	6/6	6/6	2545	4944	4594	6/6	6/12	2625	5230	4700	6/6	6/12	2670	5230	4700	6/6	6/12	2675	5220	4870	6/12	6/12		
4250	950	1000	1400	1500	1650	1750	1900	2000	2100	2500	2600	3000	3300	3500	3600	4000	2685	5180	4810	6/6	6/6	2670	5194	4844	6/6	6/12	2750	5480	4950	6/6	6/12	2795	5480	4950	6/6	6/12	2800	5470	5120	6/12	6/12		
4500	950	1000	1400	1450	1550	1700	1800	1900	1800	2400	2600	3000	3050	3500	3200	3800	2810	5630	5260	6/6	6/6	2795	5444	5094	6/6	6/12	2875	5730	5200	6/6	6/12	2920	5730	5200	6/6	6/12	2925	5720	5370	6/6	6/12		
4750	—	—	—	—	—	—	—	—	—	—	—	—	—	—	—	2800	3800	—	—	—	—	—	—	—	—	—	—	—	—	—	—	—	—	—	—	—	—	—	—	—	—	—	—
5000	850	950	1000	1300	1150	1500	1300	1700	1300	2200	2100	2850	2600	3150	2650	3700	3060	5930	5560	6/6	6/6	3045	5944	5594	6/6	6/6	3125	6230	5700	6/6	6/6	3170	6230	5700	6/6	6/6	3175	6220	5870	6/6	6/6		
5500	—	650	—	1100	—	1300	—	1500	—	1700	—	2400	—	2850	—	3200	3360	6430	6060	—	—	3345	6444	6094	—	3/6	3425	6730	6200	—	3/6	3470	6730	6200	—	3/6	3475	6720	6370	3/6	6/6		
6000	—	550	—	750	—	900	—	1300	—	1400	—	2000	—	2850	—	2900	3610	6930	6560	—	3/6	3595	6944	6594	—	3/6	3675	7230	6700	—	3/6	3720	7230	6700	—	3/6	3775	7220	6870	3/6	6/6		

BM 2-STAGE FULL FREE MAST

Lift height	Load capacity																Overall height of mast																																		
																	1-1.8t				2-2.5t				3t				3.5t				4t																		
	1t		1.5t		1.8t		2t		2.5t		3t		3.5t		4t		Forks(on the ground)	Fully extended		Free		Mast tilt angle		Forks(on the ground)	Fully extended		Free		Mast tilt angle		Forks(on the ground)	Fully extended		Free		Mast tilt angle		Forks(on the ground)	Fully extended		Free		Mast tilt angle		Forks(on the ground)	Fully extended		Free		Mast tilt angle	
	Single tire	Dual tire	Single tire	Dual tire	Single tire	Dual tire	Single tire	Dual tire	Single tire	Dual tire	Single tire	Dual tire	Single tire	Dual tire	Single tire	Dual tire		Single tire	Dual tire	Single tire	Dual tire	Single tire	Dual tire		Single tire	Dual tire	Single tire	Dual tire	Single tire	Dual tire		Single tire	Dual tire	Single tire	Dual tire	Single tire	Dual tire		Single tire	Dual tire	Single tire	Dual tire	Single tire	Dual tire		Single tire	Dual tire				
2000	1000	1000	1500	1500	1750	1750	2000	2000	2500	2500	3000	3000	3500	3500	4000	4000	1510	2930	2560	610	980	6/12	6/12	1495	2944	2594	460	810	6/12	6/12	1575	3230	2700	315	845	6/12	6/12	1670	3227	2697	315	845	6/12	6/12	1670	3220	2870	450	800	6/12	6/12
2500	1000	1000	1500	1500	1750	1750	2000	2000	2500	2500	3000	3000	3500	3500	4000	4000	1760	3430	3060	860	1230	6/12	6/12	1745	3444	3094	710	1060	6/12	6/12	1825	3730	3200	565	1095	6/12	6/12	1825	3727	3197	565	1095	6/12	6/12	1920	3720	3370	700	1050	6/12	6/12
2700	1000	1000	1500	1500	1750	1750	2000	2000	2500	2500	3000	3000	3500	3501	4000	4000	1860	3630	3260	960	1330	6/12	6/12	1845	3644	3294	810	1160	6/12	6/12	1925	3930	3400	665	1195	6/12	6/12	1925	3927	3397	665	1195	6/12	6/12	2020	3920	3570	800	1150	6/12	6/12
3000	1000	1000	1500	1500	1750	1750	2000	2000	2500	2500	3000	3000	3500	3502	4000	4000	2010	3930	3560	1110	1480	6/12	6/12	1995	3944	3594	960	1310	6/12	6/12	2075	4230	3700	815	1345	6/12	6/12	2075	4227	3697	815	1345	6/12	6/12	2170	4220	3870	950	1300	6/12	6/12
3300	1000	1000	1500	1500	1750	1750	2000	2000	2500	2500	3000	3000	3500	3503	4000	4000	2160	4230	3860	1260	1630	6/12	6/12	2145	4244	3894	1110	1460	6/12	6/12	2225	4530	4000	965	1495	6/12	6/12	2225	4527	3997	965	1495	6/12	6/12	2320	4520	4170	1100	1450	6/12	6/12
3500	1000	1000	1500	1500	1750	1750	2000	2000	2500	2500	3000	3000	3500	3504	4000	4000	2260	4430	4060	1360	1730	6/12	6/12	2245	4444	4094	1210	1560	6/12	6/12	2325	4730	4200	1065	1595	6/12	6/12	2325	4727	4197	1065	1595	6/12	6/12	2420	4720	4370	1200	1550	6/12	6/12
3600	1000	1000	1500	1500	1750	1750	2000	2000	2500	2500	3000	3000	3500	3505	4000	4000	2310	4530	4160	1410	1780	6/12	6/12	2295	4544	4194	1260	1610	6/12	6/12	2375	4830	4300	1115	1645	6/12	6/12	2375	4827	4297	1115	1645	6/12	6/12	2470	4820	4470	1250	1600	6/12	6/12
3700	1000	1000	1500	1500	1750	1750	2000	2000	2500	2500	3000	3000	3500	3506	4000	4000	2360	4630	4260	1460	1830	6/6	6/12	2345	4644	4294	1310	1660	6/6	6/12	2425	4930	4400	1165	1695	6/6	6/12	2425	4927	4397	1165	1695	6/6	6/12	2520	4920	4570	1300	1650	6/6	6/12
4000	1000	1000	1500	1500	1750	1750	2000	2000	2500	2500	2850	3000	3500	3507	4000	4000	2560	4930	4560	1660	2030	6/6	6/12	2545	4944	4594	1510	1860	6/6	6/12	2625	5230	4700	1365	1895	6/6	6/12	2625	5227	4697	1365	1895	6/6	6/12	2720	5220	4870	1450	1800	6/6	6/12
4250	950	1000	1400	1500	1650	1750	1900	2000	2100	2500	2600	3000	3300	3508	3600	4000	2685	5180	4810	1785	2155	6/6	6/12	2670	5194	4844	1635	1985	6/6	6/12	2750	5480	4950	1490	2020	6/6	6/12	2750	5477	4947	1490	2020	6/6	6/12	2845	5470	5120	1575	1925	6/6	6/12
4500	950	1000	1400	1450	1550	1700	1800	1900	1800	2400	2600	3000	3050	3509	3200	3800	2810	5630</																																	